

Sideshifting fork positioner

ZVI

integral version, integral sideshift (via valve)

The integral fork positioner ZVI uses a robust chromed bar system which is bolted to a stable frame. Hook-on or bolt on forks can be used. Integral sideshift (via valve) is standard.

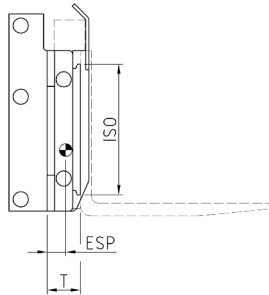
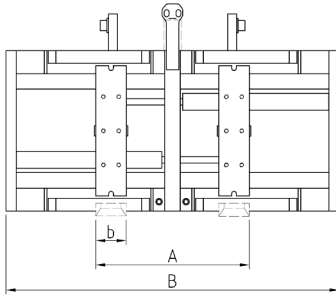

type	lift truck capacity tons	capacity kg/mm LC	B mm	A mm	b mm	T mm	ESP COG mm	weight kg
ZVI 25	1,5-2,5	2500/600	1150 1300	320-1050 320-1200	120 120	113 113	82 82	220 236
ZVI 30	3,0-3,5	3500/500	1150 1300	320-1050 320-1200	125 125	113 113	82 82	240 256
ZVI 45	4,0-5,0/600	5000/600	1350	370-1250	140	135	90	325
ZVI 50	5,0	5000/600	1420 1600	380-1300 380-1480	150 150	132 132	106 106	458 480
ZVI 60	6,0	6000/600	1600 1800	380-1480 380-1680	150 150	158 158	115 115	575 621
ZVI 80	7,0-8,0	8000/600	1800 2000	480-1680 480-1880	200 200	186 186	135 135	750 795
ZVI 100	8,0/900	8000/900	2000 2200	480-1880 480-2080	200 200	196 196	145 145	885 935
ZVI 110	8,0/1100	8000/1100	2200	480-2070	200	210	155	1040

- forks not included
- brackets, stubshafts, drawings and chain anchors must be supplied free of charge and in time to Durwen
- original forklift truck carriage and carriage drawings must be supplied free of charge and in time to Durwen
- hook-on forks or bolt-on forks can be used
- 2 hydraulic functions required
- clamping of goods is not allowed

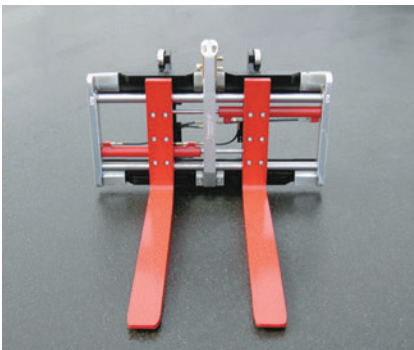

Image shows attachment with optional bolt-on forks

DURWEN 
Forklift Attachments

More than 60 years experience